



# Disclaimer

This user manual is provided as a free service by FixYourDLP.com. FixYourDLP is in no way responsible for the content of this manual, nor do we guarantee its accuracy. FixYourDLP does not make any claim of copyright and all copyrights remain the property of their respective owners.

About FixYourDLP.com

FixYourDLP.com (<http://www.fixyourdpl.com>) is the World's #1 resource for media product news, reviews, do-it-yourself guides, and manuals.

Informational Blog: <http://www.fixyourdpl.com>

Video Guides: <http://www.fixyourdpl.com/guides>

User Forums: <http://www.fixyourdpl.com/forum>

FixYourDLP's Fight Against Counterfeit Lamps:

<http://www.fixyourdpl.com/counterfeits>

## Sponsors:

RecycleYourLamp.org – Free lamp recycling services for used lamps:

<http://www.recycleyourlamp.org>

Lamp Research - The trusted 3rd party lamp research company:

<http://www.lampresearch.com>

Discount-Merchant.com – The worlds largest lamp distributor:

<http://www.discount-merchant.com>



**FixYourDLP.com**

Sponsored by 

# ***Data Projector***

---

Operating Instructions



**Discount-Merchant.com (800) 281-8860**

**THE TRUSTED SOURCE FOR PROJECTOR LAMPS AND ACCESSORIES**

***VPL-DS100***

# WARNING

**To prevent fire or shock hazard, do not expose the unit to rain or moisture.**

**To avoid electrical shock, do not open the cabinet. Refer servicing to qualified personnel only.**

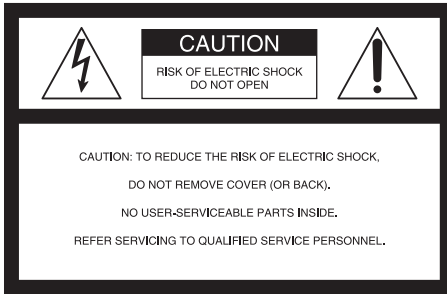

This symbol is intended to alert the user to the presence of uninsulated “dangerous voltage” within the product’s enclosure that may be of sufficient magnitude to constitute a risk of electric shock to persons.



This symbol is intended to alert the user to the presence of important operating and maintenance (servicing) instructions in the literature accompanying the appliance.

## For the customers in the USA

If you have any questions about this product, you may contact:

Sony Electronics Inc.  
Attn: Business Information Center (BIC)  
12451 Gateway Boulevard  
Ft. Myers, Florida 33913  
Telephone No.: 800-686-7669

The number below is for FCC related matters only.

## Declaration of Conformity

Trade Name: SONY  
Model No.: VPL-DS100  
Responsible Party: Sony Electronics Inc.  
Address: 680 Kinderkamack Road, Oradell,  
NJ 07649 U.S.A.  
Telephone No.: 201-930-6972

This device complies with Part 15 of the FCC Rules. Operation is subject to the following two conditions: (1) This device may not cause harmful interference, and (2) this device must accept any interference received, including interference that may cause undesired operation.

This equipment has been tested and found to comply with the limits for a Class B digital device, pursuant to Part 15 of the FCC Rules. These limits are designed to provide reasonable protection against harmful interference in a residential installation. This equipment generates, uses, and can radiate radio frequency energy and, if not installed and used in accordance with the instructions, may cause harmful interference to radio communications. However, there is no guarantee that interference will not occur in a particular installation. If this equipment does cause harmful interference to radio or television reception, which can be determined by turning the equipment off and on, the user is encouraged to try to correct the interference by one or more of the following measures:

- Reorient or relocate the receiving antenna.
- Increase the separation between the equipment and receiver.
- Connect the equipment into an outlet on a circuit different from that to which the receiver is connected.
- Consult the dealer or an experienced radio/TV technician for help.

You are cautioned that any changes or modifications not expressly approved in this manual could void your authority to operate this equipment.



FixYourDrum.com

DiscWhisperer.com  
THE TRUSTED SOURCE FOR PROJECTOR LAMPS AND ACCESSORIES

### For the customers in Canada

This Class B digital apparatus complies with Canadian ICES-003.

### Voor de klanten in Nederland



Gooi de batterij niet weg maar lever deze in als klein chemisch afval (KCA).

The socket-outlet should be installed near the equipment and be easily accessible.

#### CAUTION

RISK OF EXPLOSION IF BATTERY IS REPLACED BY AN INCORRECT TYPE. DISPOSE OF USED BATTERIES ACCORDING TO THE INSTRUCTIONS.



**Discount-Merchant.com (800) 281-8860**  
**THE TRUSTED SOURCE FOR PROJECTOR LAMPS AND ACCESSORIES**



**FixYourDLP.com**

Sponsored by 

**Discount-Merchant.com (800) 281-8860**

**THE TRUSTED SOURCE FOR PROJECTOR LAMPS AND ACCESSORIES**

---

# Table of Contents

---

## **Overview**

Precautions .....	6
Notes on Installation .....	7
Unsuitable Installation .....	7
Unsuitable Conditions .....	7
Usage in High Altitude .....	8
Features .....	8
Location and Function of Controls ..	10
Top/Front/Left Side .....	10
Rear/Right Side/Bottom .....	10
Control Panel .....	11
Connector Panel .....	13
Remote Commander .....	14

---

## **Setting Up and Projecting**

Installing the Projector .....	16
Connecting the Projector .....	17
Connecting with a Computer .....	17
Connecting with a VCR or 15k RGB/Component Equipment .....	19
Selecting the Menu Language .....	21
Projecting .....	23
Effective Tools for Your Presentation .....	28

---

## **Adjustments and Settings Using the Menu**

Using the MENU .....	30
The PICTURE SETTING Menu .....	32
The INPUT SETTING Menu .....	33
The SET SETTING Menu .....	35

The MENU SETTING Menu .....	36
The INSTALL SETTING Menu .....	37
The INFORMATION Menu .....	38

---

## **Maintenance**

Maintenance .....	39
Replacing the Lamp .....	39
Cleaning the Air Filter .....	41
Troubleshooting .....	42
Warning Messages .....	44
Caution Messages .....	45

---

## **Other**

Specifications .....	47
Index .....	Back Cover



FixYourDLP.com

DiscountMerchant.com (800) 281-8860

THE TRUSTED SOURCE FOR PROJECTOR LAMPS AND ACCESSORIES

---

## Precautions

---

### On safety

- Check that the operating voltage of your unit is identical with the voltage of your local power supply.
- Should any liquid or solid object fall into the cabinet, unplug the unit and have it checked by qualified personnel before operating it further.
- Unplug the unit from the wall outlet if it is not to be used for several days.
- To disconnect the cord, pull it out by the plug. Never pull the cord itself.
- The wall outlet should be near the unit and easily accessible.
- The unit is not disconnected to the AC power source (mains) as long as it is connected to the wall outlet, even if the unit itself has been turned off.
- Do not look into the lens while the lamp is on.
- Do not place your hand or objects near the ventilation holes. The air coming out is hot.
- Be careful not to have your fingers caught by the adjuster. The powered tilt adjuster of this unit automatically extends when the power is turned on, and is put away automatically when the power is turned off. Do not touch the unit while the adjuster is in operation. Adjust the powered tilt adjuster carefully after its automatic operation is completed.
- Do not spread a cloth or paper under the unit.

---

### On illumination

- To obtain the best picture, the front of the screen should not be exposed to direct sunlight.
- Ceiling-mounted spot lighting is recommended. Use a cover over fluorescent lamps to avoid lowering the contrast ratio.
- Cover any windows that face the screen with opaque draperies.
- It is desirable to install the projector in a room where floor and walls are not of

light-reflecting material. If the floor and walls are of reflecting material, it is recommended that the carpet and wall paper be changed to a dark color.

---

### On preventing internal heat build-up

After you turn off the power with the I / ⏻ key, do not disconnect the unit from the wall outlet while the cooling fan is still running.

### Caution

The projector is equipped with ventilation holes (intake) and ventilation holes (exhaust). Do not block or place anything near these holes, or internal heat build-up may occur, causing picture degradation or damage to the projector.

---

### On cleaning

- To keep the cabinet looking new, periodically clean it with a soft cloth. Stubborn stains may be removed with a cloth lightly dampened with a mild detergent solution. Never use strong solvents, such as thinner, benzene, or abrasive cleansers, since these will damage the cabinet.
- Avoid touching the lens. To remove dust on the lens, use a soft dry cloth. Do not use a damp cloth, detergent solution, or thinner.
- Clean the filter at regular intervals.

---

### On LCD data projector

- The LCD data projector is manufactured using high-precision technology. You may, however, see tiny black points and/or bright points (red, blue, or green) that continuously appear on the LCD data projector. This is a normal result of the manufacturing process and does not indicate a malfunction.



FixYourDisplay.com

Discover the difference at [www.fixyourdisplay.com](http://www.fixyourdisplay.com) (800) 281-8860

THE TRUSTED SOURCE FOR PROJECTOR LAMPS AND ACCESSORIES

# Notes on Installation

## Unsuitable Installation

Do not install the projector in the following situations. **These installations may cause malfunction or damage** to the projector.

### Poorly ventilated



- Allow adequate air circulation to prevent internal heat build-up. Do not place the unit on surfaces (rugs, blankets, etc.) or near materials (curtains, draperies) that may block the ventilation holes. When the internal heat builds up due to the block-up, the temperature sensor will function with the message “High temp.! Lamp off in 1 min.” The power will be turned off automatically after one minute.
- Leave space of more than 30 cm (11 7/8 inches) around the unit.
- Be careful that the ventilation holes may inhale tininess such as a piece of paper.

### Highly heated and humid

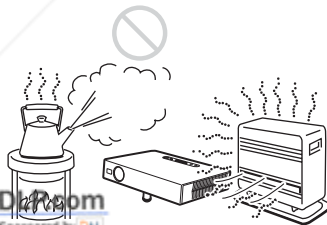

- Avoid installing the unit in a location where the temperature or humidity is very high, or temperature is very low.
- To avoid moisture condensation, do not install the unit in a location where the temperature may rise rapidly.

### Very dusty

Avoid installing the unit in a location where there is a lot of dust; otherwise, the air filter will be obstructed. The dust blocking the air through the filter may cause raising the internal heat of the projector. Clean it up periodically.

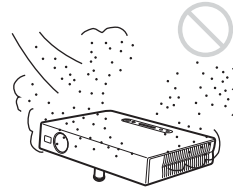

## Unsuitable Conditions

Do not use the projector under the following conditions.

### Topping the unit

Avoid using as the unit topples over on its side. It may cause malfunction.

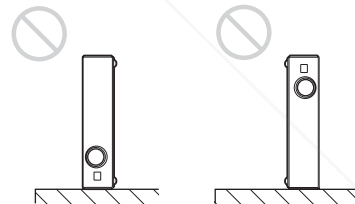

### Tilting the unit out of the range of the adjuster setting

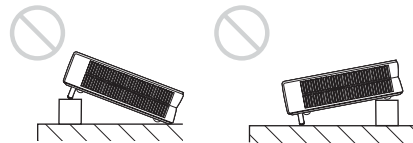

Avoid using when the unit is tilted out of the range of the adjuster setting. Such installation may cause color shading or shorten excessively the lamp life.



### Tilting the unit to the right or left

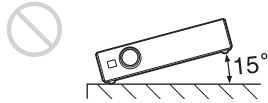

Avoid tilting the unit to an angle of 15°, and avoid installing the unit in any way other than placing on the floor or suspending from the ceiling. Such installation may cause color shading or shorten the lamp life excessively.

### Blocking the ventilation holes

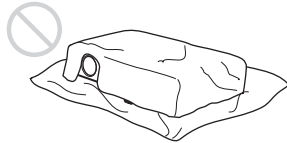

Avoid using something to cover over the ventilation holes (exhaust/intake); otherwise, the internal heat may build up.

*For details on the ventilation holes (intake/exhaust), see “Location and Function of Controls” on page 10.*

### Usage in High Altitude

When using the projector at an altitude of 1,500 m or higher, turn on “High Altitude Mode” in the INSTALL SETTING menu. Failing to set this mode when using the projector at high altitudes could have adverse effects, such as reducing the reliability of certain components.

*For details on “High Altitude Mode,” see “High Altitude Mode” in the INSTALL SETTING menu on page 37.*

#### Notes

- The unit is manufactured using high-precision technology. When transporting the unit stored in the soft case, do not drop the unit or subject it to shock, as this may cause damage. When storing the unit in the soft case, disconnect the AC power cord

and all other connecting cables, and store the supplied accessories in a pocket of the soft case.

- When using a screen with an uneven surface, stripes pattern may rarely appear on the screen depending on the distance between the screen and the projector or the zooming magnifications. This is not a malfunction of the projector.

## Features

### High brightness, high picture quality

- **High brightness**  
Adopting Sony’s unique, high-efficiency optical system and the 157 W UHP lamp allows high brightness (light output 1200 ANSI lumen).
- **High resolution**  
Three superhigh-aperture 0.62-inch SVGA panels with approximately 480,000 pixels provide a resolution of 800 × 600 dots (horizontal/vertical) for RGB input, and 600 horizontal TV lines for video input.

### High operability

- **Intelligent Auto-setup function**  
Simply press the power key, and the projector automatically performs the setups required before use. The projector opens the lens protector, corrects the V Keystone, and sets optimum conditions for projection. This function is called Intelligent Auto-setup.  
For easier operations, the keys that will be used frequently are allocated on the top of the projector.

### Short focus lens equipped

This projector is equipped with a short focus lens that allows outputting to a larger screen even in a limited space.



FixYourDLP.com

Notes

Discount-Merchant.com (800) 281-8860  
THE TRUSTED SOURCE FOR PROJECTOR LAMPS AND ACCESSORIES

---

### Accepts various input signals

- **Scan converter loaded**  
This projector has a build-in scan converter that converts the input signal within 800 × 600 dots.
- **Compatible input signals**  
This projector accepts video signals of composite, S video, component and DTV as well as VGA, SVGA and XGA signals, which all can be displayed.
- **Compatible with six color systems**  
NTSC, PAL, SECAM, NTSC<sup>4.43</sup>\*, PAL-M, or PAL-N color system can be selected automatically.

---

### Easy presentation

- **Simple setup with external equipment**  
This projector is preset for 32 kinds of input signals. You can project images from an external signal source just by connecting the equipment with the supplied cable.

---

### Easy-to-use Remote Commander

The Remote Commander is equipped with various convenient keys, including the D ZOOM key for zooming in on the image and the FREEZE key for keeping the image projected even if the equipment is disconnected.

---

### High portability

- **Light weight/small size/simple design**  
This projector has been miniaturized to approx. 2.8 kg (6 lb 3 oz) in weight and B5-file size.  
Its simple yet sophisticated design fits comfortably in your office.

---

### Security lock

By setting a password, you can enable the security lock to function for this projector.

---

\* NTSC<sup>4.43</sup> is the color system used when playing back a video recorded on NTSC on a NTSC<sup>4.43</sup> system VCR.

Windows is a registered trademark of Microsoft Corporation in the United States and/or other countries.

IBM PC/AT, VGA, SVGA and XGA are registered trademarks of the International Business Machines Corporation, U.S.A.

Kensington is a registered trademark of Kensington Technology Group.

Macintosh is a registered trademark of Apple Computer, Inc.

VESA is a registered trademark of Video Electronics Standard Association.

Display Data Channel is a trademark of Video Electronics Standard Association.



FixYourDLP.com

DiscWorld.com (800) 281-8860  
THE #1 SOURCE FOR PROJECTOR PARTS AND ACCESSORIES

# Location and Function of Controls

## Top/Front/Left Side

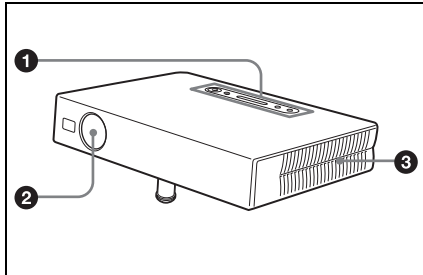

## Rear/Right Side/Bottom

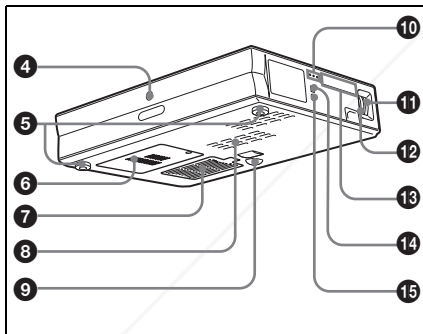

### 1 Control panel

For details, see “Control Panel” on page 11.

### 2 Lens protector (lens cover)

The lens protector automatically opens when the power is turned on.

### 3 Ventilation holes (exhaust)

### 4 Remote control detector

### 5 Adjuster (hind pad)

Turn the adjuster to the right or left for minor tilt adjustment of the projected picture.

### 6 Ventilation holes (intake)/Lamp cover

### 7 Ventilation holes (intake)/air filter cover

#### Notes

- Do not place anything near the ventilation holes as it may cause internal heat build-up.
- Do not place your hand or objects near the ventilation holes as it may cause the air coming out heat build-up.
- To maintain optimal performance, clean the air filter every 500 hours.

For details, see “Cleaning the Air Filter” on page 41.

### 8 Ventilation holes (intake)

### 9 Powered tilt adjuster

### 10 Indicators

#### POWER SAVING

Lights up when the projector is in power saving mode. When “Power Saving” in the SET SETTING menu is set to “ON,” the projector goes into power saving mode if no signal is input for 10 minutes. Although the lamp goes out, the cooling fan keeps running. The power saving mode is canceled when a signal is input or any key is pressed. In power saving mode, any key does not function for the first 60 seconds after the lamp goes out.

#### TEMP (Temperature)/FAN

Lights up or flashes under the following conditions:

- Lights up when temperature inside the projector becomes unusually high.
- Flashes when the fan is broken.

For details on the TEMP/FAN indicator, see page 44.

#### LAMP/COVER

Lights up or flashes under the following conditions:

- Lights up when the lamp has reached the end of its life or becomes a high temperature.



FixYourDLP.com

Discount Merchant.com (800) 281-8860

THE #1 RATED SOURCE FOR PROJECTOR LIGHT BULBS AND ACCESSORIES

- Flashes when the lamp cover is not secured firmly.

For details on the LAMP/COVER indicator, see page 44.

- 11 Focus ring**  
Adjusts the picture focus.
- 12 Zoom ring**  
Adjusts the picture size.
- 13 Connector panel**  
For details, see “Connector Panel” on page 13.
- 14 Speaker**
- 15 Security lock**  
Connects to an optional security cable (Kensington’s).  
Web page address:  
<http://www.kensington.com/>

## Control Panel

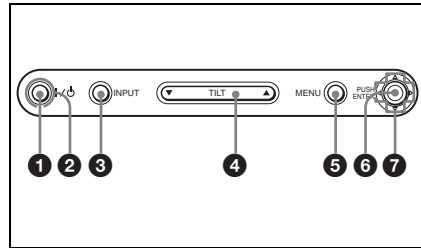

Overview

- 1 I / ⏻ (on/standby) key**  
Turns on the projector when the projector is in standby mode. The ON/STANDBY indicator around the I / ⏻ key lights in green when the power is turned on.  
**When turning off the power, press the I / ⏻ key twice following the message on the screen, or press and hold the key for about two seconds.**  
For details on steps for turning off the power, see “To turn off the power” on page 27.

- 2 ON/STANDBY indicator (located around the I / ⏻ key)**  
Lights up or flashes under the following conditions:
  - Lights in red when a AC power cord is plugged into a wall outlet. Once in standby mode, you can turn on the projector with the I / ⏻ key.
  - Lights in green when the power is turned on.
  - Flashes in green while the cooling fan runs after the power is turned off with the I / ⏻ key. The fan runs for about 90 seconds after the power is turned off.
 The ON/STANDBY indicator flashes quickly for the first 60 seconds. During this time, you cannot light up the ON/STANDBY indicator with the I / ⏻ key.

For details on the LAMP/COVER and the TEMP/FAN indicators, see on page 44.



**Discount-Merchant.com** (800) 281-8860  
THE TRUSTED SOURCE FOR PROJECTOR PARTS AND ACCESSORIES

### 3 INPUT key

Selects the input signal. Each time you press the key, the input signal switches as follows:



### 4 TILT adjustment key

For details, see “How to use the powered tilt adjuster” on page 12.

### 5 MENU key

Displays the on-screen menu. Press again to clear the menu.

### 6 ENTER key

Enters the settings of items in the menu system.

### 7 Arrow keys (▲/▼/◀/▶)

Select the menu or to make various adjustments.

## How to use the powered tilt adjuster

### To adjust the height

Adjust the height of the projector as follows:

#### 1 Press the I / ⏻ key

The lens protector opens, and the powered tilt adjuster rises automatically. The adjuster stops at its previously adjusted position.

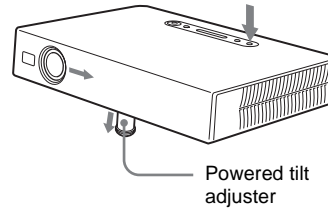

#### 2 Press ▲ or ▼ of the TILT key to adjust the tilt of the projector.

You may press the D KEYSTONE key on the Remote Commander to display the Tilt menu and adjust the tilt using the ▲/▼/◀/▶ keys.

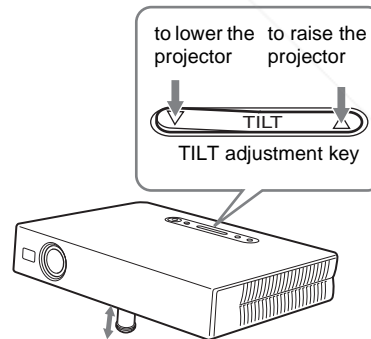

### Notes

- Be careful not to let the projector down on your fingers.
- Do not push hard on the top of the projector with the powered tilt adjuster out. It may be occurred malfunction.

## Connector Panel

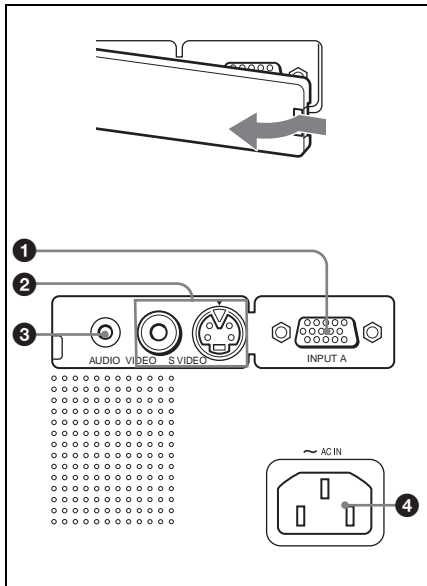

### 1 INPUT A connector (HD D-sub 15-pin, female)

Connect to external equipment such as a computer.

Connects to the monitor output on a computer using the supplied cable. When inputting a component or 15k RGB signal, use an optional cable.

*For details, see "To connect a 15k RGB/Component equipment" on page 19.*

### 2 Video input connector

Connect to external video equipment such as a VCR.

- **VIDEO (phono type):** Connects to the composite video output of video equipment.

- **S VIDEO (mini DIN 4-pin):**

Connects to the S video output (Y/C video output) of video equipment.

### 3 AUDIO (stereo minijack) connector

When listening to sound output from the computer, connect to the audio output of the computer.

When listening to sound output from the VCR, connect to the audio output of the VCR.

### 4 AC IN socket

Connects the supplied AC power cord.

Overview



**Discount-Merchant.com (800) 281-8860**  
**THE TRUSTED SOURCE FOR PROJECTOR LAMPS AND ACCESSORIES**

## Remote Commander

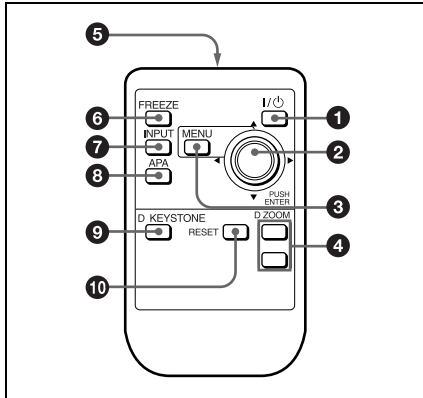

### 1 I / $\text{\textcircled{I}}$ (on/standby) key

### 2 ENTER/arrow key ( $\blacktriangle/\blacktriangledown/\blacktriangleleft/\blacktriangleright$ )

Press the center of the key to use ENTER.

### 3 MENU key

### 4 D ZOOM +/- key

Enlarges the image at a desired location on the screen.

+: Pressing the + key once displays the icon. This icon indicates the point you want to enlarge. Use an arrow key ( $\blacktriangle/\blacktriangledown/\blacktriangleleft/\blacktriangleright$ ) to move the icon to the point to be enlarged. Press the + key repeatedly until the image is enlarged to your requirements.

-: Pressing the - key reduces an image that has been enlarged with the D ZOOM + key.

### 5 Infrared transmitter

### 6 FREEZE key

Used to freeze the picture projected. To cancel the freeze function, press the key again.

### 7 INPUT key

### 8 APA (Auto Pixel Alignment) key

Adjusts a picture clearest automatically while a signal is input from a computer.

Used when “Smart APA” in the SET SETTING menu is set to “Off.” Normally set to “On.”

### 9 D KEYSTONE key

Used to adjust the tilt of the projector, or the trapezoidal distortion of the image manually. Each time you press this key, the Tilt menu and the V Keystone menu is displayed alternately. Use the arrow key ( $\blacktriangle/\blacktriangledown/\blacktriangleleft/\blacktriangleright$ ) for the adjustment.

### 10 RESET key

Resets the value of an item back to its factory preset value or returns the enlarged image back to its original size. This key functions when the menu or a setting item is displayed on the screen.

## Before using the Remote Commander

Pull out the clear film from the lithium battery holder.

## To replace battery

- 1 Release the lock of the lithium battery holder by picking it, and pull out the holder from the Remote Commander.

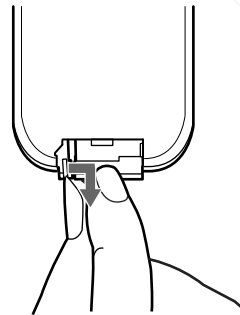

FixYourDLP.com  
Sponsored by DLP

Discount-Merchant.com (800) 281-8860  
THE TRUSTED SOURCE FOR PROJECTOR LAMPS AND ACCESSORIES

**2** Install the lithium battery.

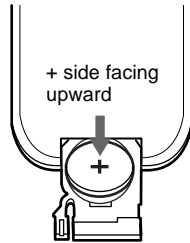

**3** Put the lithium battery holder back into the Remote Commander.

**Notes on the lithium battery**

- Keep the lithium battery out of the reach of children.
- Should the battery be swallowed, immediately consult a doctor.

**Notes on Remote Commander operation**

- Make sure that nothing obstructs the infrared beam between the Remote Commander and the remote control detector on the projector. Direct the Remote Commander toward the remote control detector.
- The operation range is limited. The shorter the distance between the Remote Commander and the remote control detector is, the wider the angle within which the commander can control the projector becomes.



## Installing the Projector

This section describes how to install the projector. The distance between the lens and the screen varies depending on the size of the screen. Use the following table as a guide.

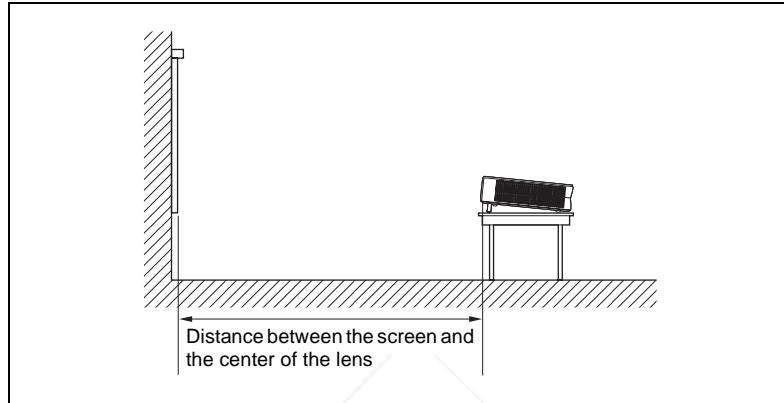

Unit: m (feet)

Screen size (inches)	40	60	80	100	120	150
Minimum Distance	1.1 (3.6)	1.7 (5.6)	2.3 (7.5)	2.9 (9.5)	3.5 (11.5)	4.4 (14.4)
Maximum Distance	1.4 (4.6)	2.1 (6.9)	2.8 (9.2)	3.5 (11.5)	4.2 (13.8)	5.3 (17.4)

There may be a slight difference between the actual value and the design value shown in the table above.

### Note

When using the projector by suspending it from the ceiling, consult with qualified Sony personnel. (fee charged)



**Discount-Merchant.com (800) 281-8860**  
THE TRUSTED SOURCE FOR PROJECTOR LAMPS AND ACCESSORIES

# Connecting the Projector

**When you connect the projector, make sure to:**

- Turn off all equipment before making any connections.
- Use the proper cables for each connection.
- Insert the cable plugs firmly; loose connections may increase noise and reduce performance of picture signals. When pulling out a cable, be sure to pull it out from the plug, not the cable itself

**To connect the projector, refer to the illustrations on the next and the following pages.**

## Connecting with a Computer

This section describes how to connect the projector to a computer. For more information, refer to the computer's instruction manual.

### Notes

- The projector accepts VGA, SVGA, XGA signals. However, we recommend that you set the output mode of your computer to SVGA mode for the external monitor.
- If you set your computer, such as a notebook type, to output the signal to both your computer's display and the external monitor, the picture of the external monitor may not appear properly. Set your computer to output the signal to only the external monitor.

*For details, refer to the computer's operating instructions supplied with your computer.*

- This projector is compatible with a DDC2B (Digital Data Channel 2B). If your computer is compatible with a DDC, turn the projector on according to the following procedures.

**1** Connect the projector to the computer by using the supplied HD D-sub 15 pin cable.

**2** Turn the projector on.

**3** Start the computer.

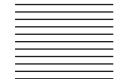

**Discount-Merchant.com (800) 281-8860**  
**THE TRUSTED SOURCE FOR PROJECTOR LAMPS AND ACCESSORIES**

## To connect an IBM PC/AT compatible computer

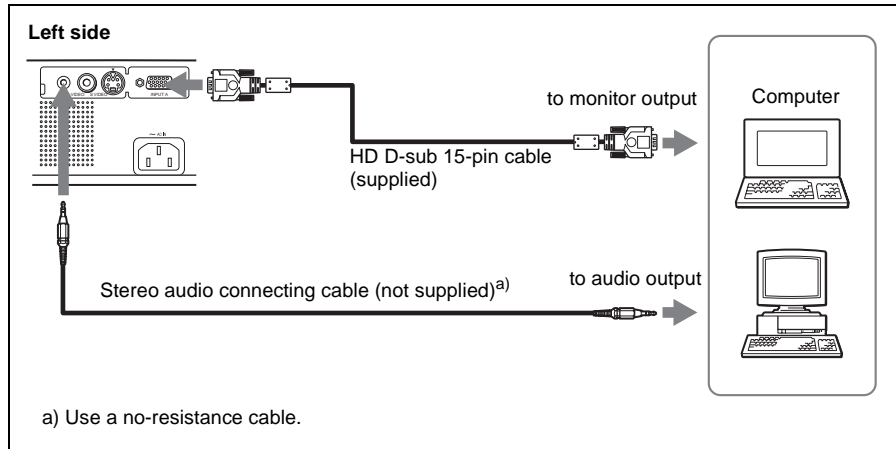

## To connect a Macintosh computer

To connect a Macintosh computer equipped with video output connector of a type having two rows of pins, use a commercially available plug adaptor.



**Discount-Merchant.com (800) 281-8860**  
**THE TRUSTED SOURCE FOR PROJECTOR LAMPS AND ACCESSORIES**

## Connecting with a VCR or 15k RGB/Component Equipment

This section describes how to connect the projector to a VCR and 15k RGB/component equipment.

For more information, refer to the instruction manuals of the equipment you are connecting.

### To connect a VCR

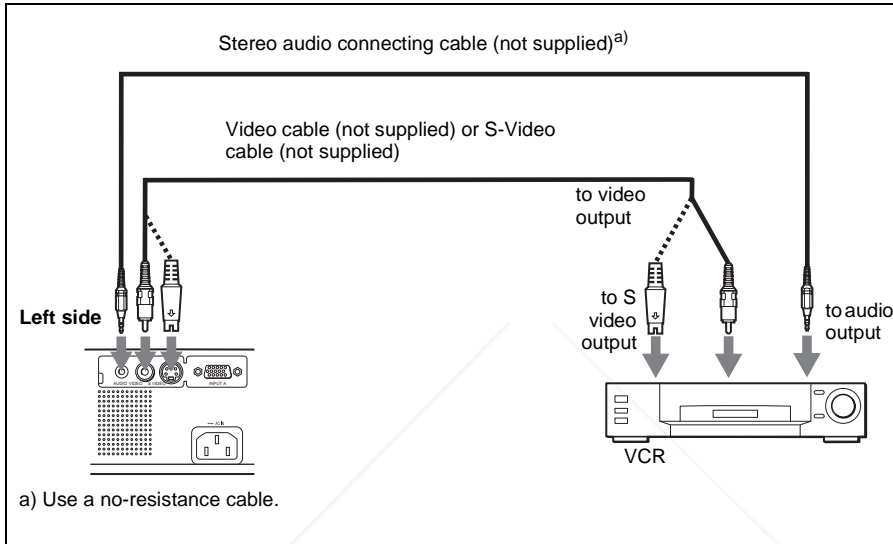

Setting Up and Projecting

### To connect a 15k RGB/Component equipment

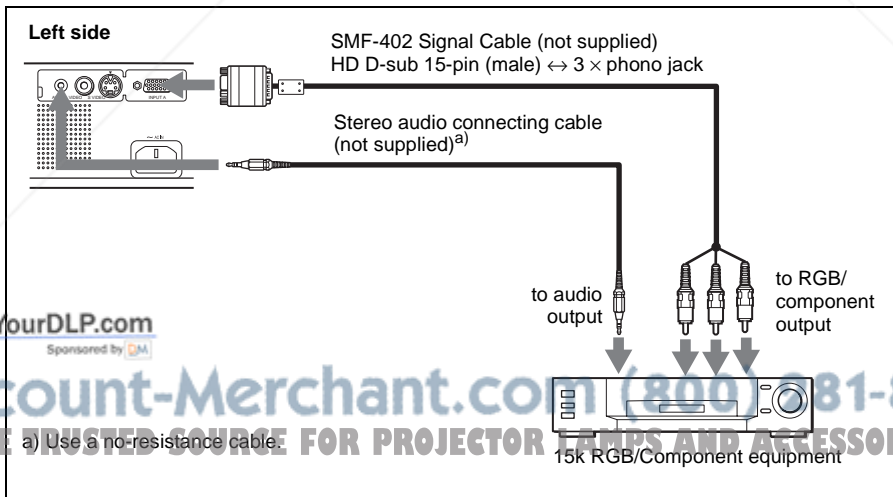

FixYourDLP.com  
Sponsored by DM

Discount-Merchant.com (800) 381-8860  
THE TRUSTED SOURCE FOR PROJECTOR PARTS AND ACCESSORIES

### Notes

- Set the aspect ratio using “Wide Mode” in the INPUT SETTING menu according to the input signal.
- When you connect the unit to 15k RGB or component video equipment, select video GBR or component with the “Input-A Signal Sel.” setting in the SET SETTING menu.
- Use the composite sync signal when you input the external sync signal from 15k RGB/component equipment.



**Discount-Merchant.com (800) 281-8860**  
**THE TRUSTED SOURCE FOR PROJECTOR LAMPS AND ACCESSORIES**

# Selecting the Menu Language

You can select one of thirteen languages for displaying the menu and other on-screen displays. The factory setting is English.

To change the menu language, proceed as follows:

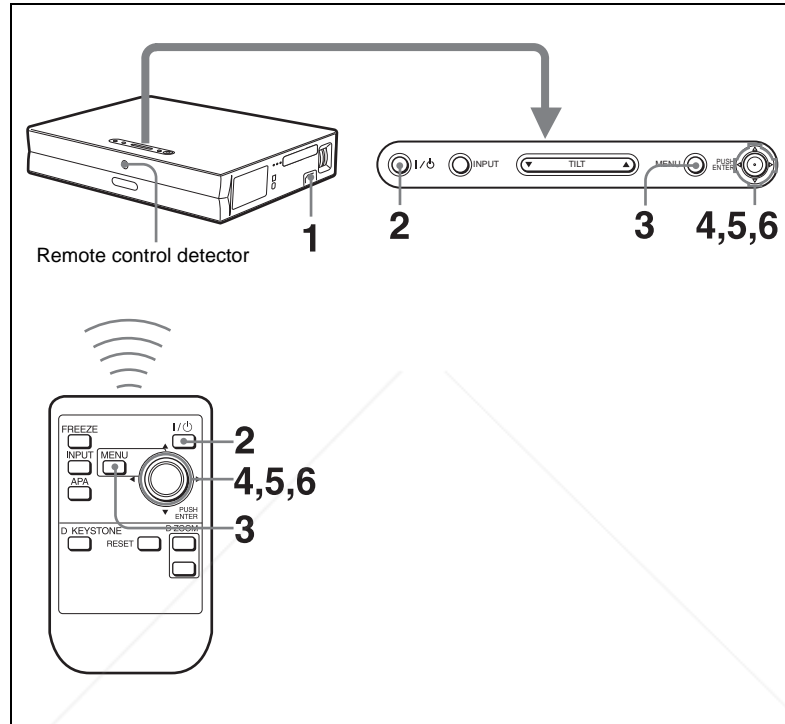

Setting Up and Projecting

- 1 Plug the AC power cord into a wall outlet.
- 2 Press the I / ⏻ key to turn on the projector.
- 3 Press the MENU key.  
The menu appears.  
The menu presently selected is shown as a yellow button.



Sponsored by

DiscountMerchant.com (800) 281-8860  
THE TRUSTED SOURCE FOR PROJECTOR LAMPS AND ACCESSORIES

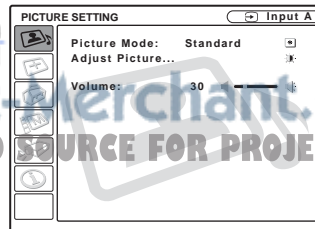

- 4 Press the ▲ or ▼ key to select the MENU SETTING menu, then press the ► or ENTER key.  
The selected menu appears.

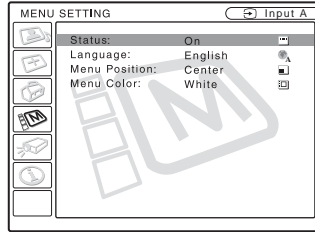

- 5 Press the ▲ or ▼ key to select “Language,” then press the ► or ENTER key.

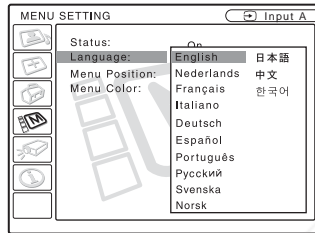

- 6 Press the ▲, ▼, ◀ or ▶ key to select a language, then press the ENTER key.  
The menu changes to the selected language.

#### To clear the menu

Press the MENU key.

The menu disappears automatically if a key is not pressed for one minute.



**Discount-Merchant.com (800) 281-8860**  
**THE TRUSTED SOURCE FOR PROJECTOR LAMPS AND ACCESSORIES**

# Projecting

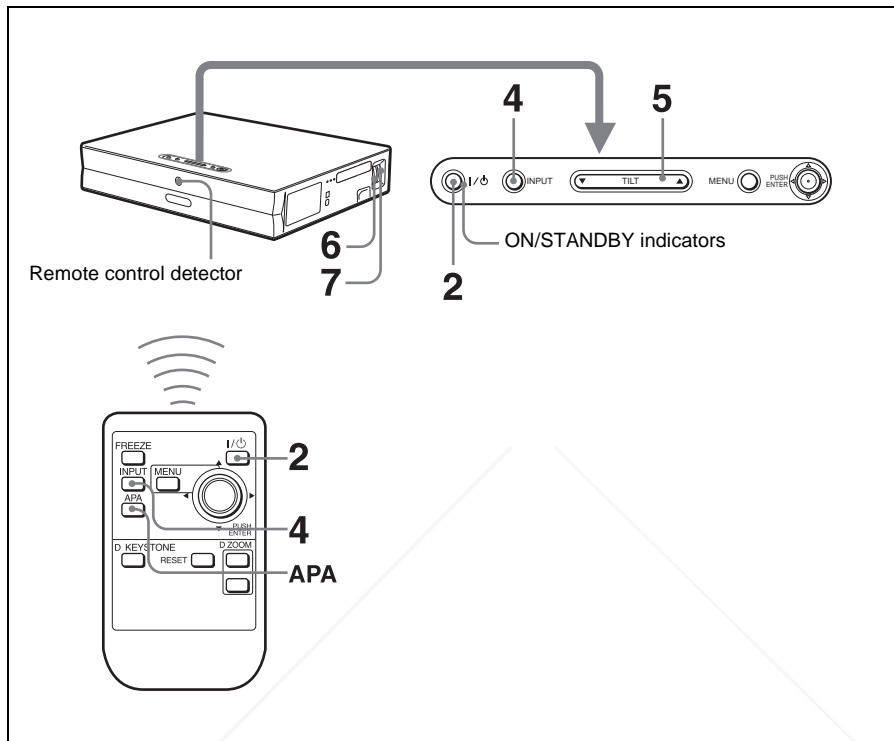

- 1** Plug the AC power cord into a wall outlet, then connect all equipment. The ON/STANDBY indicator lights in red and the projector goes into standby mode.
- 2** Press the I / ⏻ key. The ON/STANDBY indicator lights in green and the Intelligent Auto-setup starts. The lens protector opens, and the powered tilt adjuster rises and stops at the previously adjusted position.
- 3** Turn on the equipment connected to the projector.



FixYourDLP.com

Sponsored by DM

DiscountProjector.com (800) 281-8860

THE TRUSTED SOURCE FOR PROJECTOR LAMPS AND ACCESSORIES



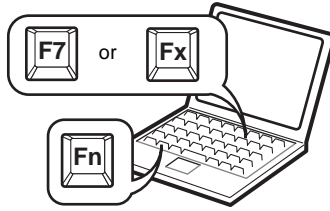

Fx:“x” indicate an optional numerical value. The Fx key varies depending on a computer’s makers.

**4** Press the INPUT key to select the input source.

To input from	Press INPUT to display
Computer connected to the INPUT A connector	INPUT A
Video equipment connected to the VIDEO input connector	VIDEO
Video equipment connected to the S VIDEO input connector	S VIDEO

Smart APA (Auto Pixel Alignment) adjusts the picture of the connected equipment so that it is projected clearly.

**Notes**

- If “Auto Input Search” is set to “On,” the projector searches for the signals from the connected equipment and displays the input channel where the input signals are found.

*For details, see “Auto Input Search” in the SET SETTING menu on page 35.*

- The Smart APA is effective for the input signal from a computer only.

**5** Adjust the position of the picture by pressing the TILT key.

To adjust the position of the picture using the Remote Commander, press the D KEYSTONE key on the Remote Commander to display the Tilt menu and adjust the tilt using the ▲/▼/◀/▶ keys.

*For details on the TILT adjustment key, see “How to use the powered tilt adjuster” on page 12.*

**Note**

When you adjust the powered tilt adjuster with the TILT key, the automatic keystone adjustment is performed at the same time. If you do not want to perform the automatic keystone adjustment, set the V Keystone menu to “Manual.” (See page 37)

**6** Turn the zoom ring to adjust the size of the picture.

**7** Turn the focus ring to adjust the focus.



**Discount Merchant.com (800) 281-8860**  
**THE TRUSTED SOURCE FOR PROJECTOR LAMPS AND ACCESSORIES**

### Note

The auto V keystone adjustment may not correct the trapezoidal distortion perfectly, depending on the room temperature or the screen angle. In this case, adjust it manually. Press the D KEYSTONE key on the Remote Commander until “V Keystone” appears on the screen, and adjust the value with the ▲/▼/◀/▶ key. The corrected value is effective until the power turn off.

### Attention

Looking into the lens when projecting may cause injury to your eyes.

### To switch from the Intelligent Auto-setup function to manual adjustments

You can switch the following functions of the Intelligent Auto-setup to manual adjustments using the menu.

- **V Keystone correction (correction of trapezoidal distortion)**  
Set “V Keystone” in the INSTALL SETTING menu to “Manual.”
- **Smart APA (Auto Pixel Alignment)**  
Set “Smart APA” in the SET SETTING menu to “Off.”
- **Auto Input Search**  
Set “Auto Input Search” in the SET SETTING menu to “Off.”

For details on the menu operations, see “Using the MENU” on page 30.

### To adjust the volume

The volume can be adjusted in the on-screen menu. See “Volume” in the PICTURE SETTING menu on page 32.

### To use the security lock

The security lock prevents use of the projector unless a password is set.

- 1 Press the MENU key and then, in the INSTALL SETTING menu, turn on the “Security Lock” setting.
- 2 Enter the password.  
Use the MENU, ▲/▼/◀/▶, and ENTER keys to enter the four-digit password. (The default setting is “ENTER, ENTER, ENTER, ENTER.”)

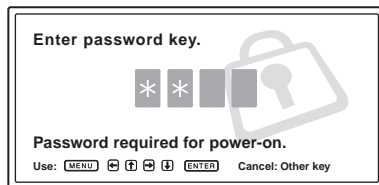

**Discount-Merchant.com (800) 281-8860**  
**THE TRUSTED SOURCE FOR PROJECTOR LAMPS AND ACCESSORIES**

Next, the screen for entering a new password is displayed. (Enter the current password at this screen if you want to keep it.)

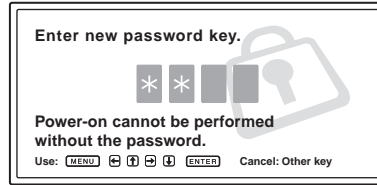

**3** Enter the password again to confirm.



If the password is entered incorrectly, the menu screen displays an “Invalid Password!” message.

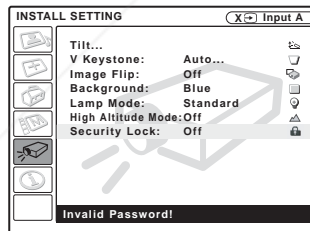

**4** The security lock is completed.

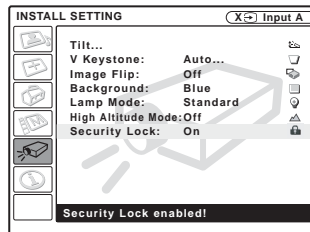

**Notes**

- You will not be able to use the projector if you forget your password and the password administrator is not available. Be please aware that using the security lock can prevent valid usage in such cases. It is recommended that you make a note of the selected password.
- If you fail to enter the correct password after three tries, the projector cannot be used. In this case, press the I / ⏻ key to turn off the power.
- The security lock will not be set if the correct password is not entered in steps 2 and 3, or a key other than the MENU, arrow keys (▲/▼/◀/▶), and ENTER key is pressed.
- If you call the customer service center because you have forgotten the password, you will need to be able to verify the projector's serial number and your identity. (This process may differ in other countries.) Once your identity has been confirmed, we will provide you with the password.

**To turn off the power**

- 1 Press the I / ⏻ key.  
“POWER OFF? Please press I / ⏻ key again.” appears to confirm that you want to turn off the power.

**Note**

A message disappears if you press any key except the I / ⏻ key, or if you do not press any key for five seconds.

- 2 Press the I / ⏻ key again.  
The powered tilt adjuster is put away in the projector and the lens protector closes. The ON/STANDBY indicator flashes in green and the fan continues to run for about 90 seconds to reduce the internal heat. Also, the ON/STANDBY indicator flashes quickly for the first 60 seconds. During this time, you will not be able to light up again the ON/STANDBY indicator with the I / ⏻ key.
- 3 Unplug the AC power cord from the wall outlet after the fan stops running and the ON/STANDBY indicator lights in red.

**When you cannot confirm the on-screen message**

When you cannot confirm the on-screen message in a certain condition, you can turn off the power by holding the I / ⏻ key for about two seconds.

**Note**

**Do not unplug the AC power cord while the fan is still running;** otherwise, the fan will stop even though the internal heat is still high, which could result in a breakdown of the projector.

**On air filter**

To maintain optimal performance, **clean the air filter every 500 hours.**

For details, see “Cleaning the Air Filter” on page 41.



FixYourDLP.com

Sponsored by

Discount-Merchant.com (800) 281-8860

THE TRUSTED SOURCE FOR PROJECTOR LAMPS AND ACCESSORIES

## Effective Tools for Your Presentation

### To enlarge the image (Digital Zoom function)

You can select a point in the image to enlarge. This function works when a signal from a computer is input.

This function does not work when a video signal is input.

- 1 Project a normal image, and press the D ZOOM + key on the Remote Commander.

The digital zoom icon appears in the center of the image.

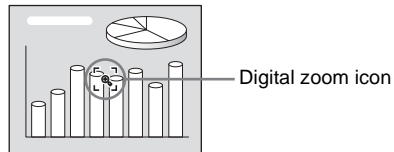

- 2 Move the icon to the point on the image you want to enlarge. Use the arrow key (↑/↓/←/→) to move the icon.

- 3 Press the D ZOOM + key again.

The image where the icon is located is enlarged. The enlargement ratio is displayed on the screen for a few seconds.

By pressing the + key repeatedly, the image size increases (ratio of enlargement: max. 4 times.)

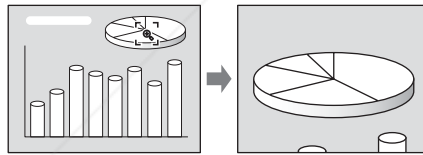

Use the arrow key (↑/↓/←/→) to scroll the enlarged image.

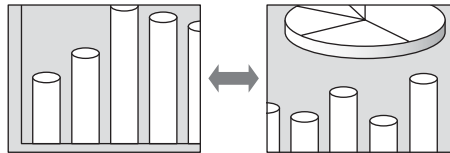

### To return the image back to its original size

Press the D ZOOM – key.

Just pressing the RESET key returns the image back to its original size immediately.



FixYourDLP.com

Sponsored by

Press the D ZOOM – key.

Discount-[Merchant.com](http://Discount-Merchant.com) (800) 281-8860

THE TRUSTED SOURCE FOR PROJECTOR LAMPS AND ACCESSORIES

### To freeze the image projected (Freeze function)

Press the FREEZE key. "Freeze" appears when the key is pressed. This function works when a signal from a computer is input.

To restore the original screen, press the FREEZE key again.

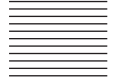

**Discount-Merchant.com (800) 281-8860**  
**THE TRUSTED SOURCE FOR PROJECTOR LAMPS AND ACCESSORIES**

## Using the MENU

The projector is equipped with an on-screen menu for making various adjustments and settings. The setting items are displayed in a pop-up menu or in a sub menu. If you select an item name followed by dots (...), a sub menu with setting items appear. You can change the tone of the menu display and the menu language displayed in the on-screen menu.

To change the menu language, see “Selecting the Menu Language” on page 21.

### Display items

Input signal indicator



Input signal setting indicator

Picture adjustment menu

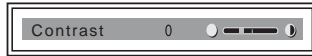

#### Input signal indicator

Shows the selected input channel. is displayed when no signal is input. You can hide this indicator using “Status” in the MENU SETTING menu.

#### Input signal setting indicator

For Input A: Shows “Computer,” “Component” or “Video GBR.”

For Video/S Video input: Shows “Auto” or the “Color System” setting in the SET SETTING menu.

### 1 Press the MENU key.

The menu appears.

The menu presently selected is shown as a yellow button.

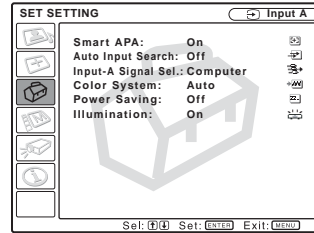

### 2 Use the ▲ or ▼ key to select a menu, then press the ► or ENTER key.

The selected menu appears.

### 3 Select an item.

Use the ▲ or ▼ key to select the item, then press the ► or ENTER key.

The setting items are displayed in a pop-up menu or in a sub menu.

#### Pop-up menu

Menu    Setting items    Selected input signal

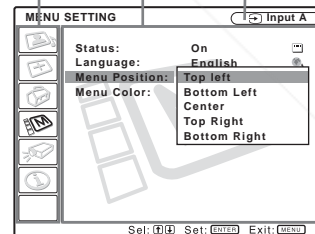

#### Sub menu

Menu    Setting items

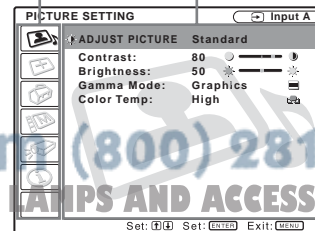

- 4** Make the setting or adjustment on an item.
- When changing the adjustment level:  
To increase the number, press the ▲ or ► key.  
To decrease the number, press the ▼ or ◀ key.  
Press the ENTER key to restore the previous screen.
  - When changing the setting:  
Press the ▲ or ▼ key to change the setting.  
Press the ENTER or ◀ key to restore the previous screen.

When setting the Menu Language, see “Selecting the Menu Language” on page 21.

---

### To clear the menu

Press the MENU key.  
The menu disappears automatically if a key is not pressed for one minute.

---

### To reset items that have been adjusted

Press the RESET key on the Remote Commander.  
“Complete!” appears on the screen and **the settings appearing on the screen are reset to their factory preset values.**  
Items that can be reset are:

- “Contrast,” “Brightness,” “Color,” “Hue,” and “Sharpness” in the Adjust Picture... menu.
- “Dot Phase,” “H Size,” and “Shift” in the Adjust Signal... menu

---

### About the memory of the settings

The settings are automatically stored in the projector memory.

---

### If no signal is input

If there is no input signal, “Cannot adjust this item.” appears on the screen.

---

### About the menu display

You can set the display position of the menu, intensity of the background picture and tone of the menu items as you like.

For details, see “The MENU SETTING Menu” on page 36.

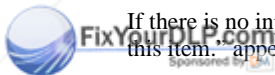
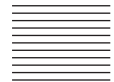

**Discount-Merchant.com (800) 281-8860**  
**THE TRUSTED SOURCE FOR PROJECTOR LAMPS AND ACCESSORIES**



# The PICTURE SETTING Menu

The PICTURE SETTING menu is used for adjusting the picture or volume. Items that cannot be adjusted depending on the input signal are not displayed in the menu.

*For details on the unadjustable items, see page 49.*

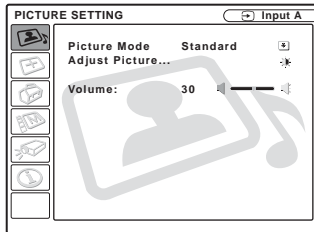

## Menu Items

### Picture Mode

Selects the picture mode.

**Dynamic:** Emphasizes the contrast to produce a “dynamic” picture.

**Standard:** Normally select this setting. If the picture has roughness with the “Dynamic” setting, this setting reduces the roughness.

### Volume

Adjusts the volume.

### Adjust Picture... Menu Items

The unit can store the setting values of the following sub-menu items for each “Dynamic” or “Standard” picture mode separately.

## Adjust Picture...

### When the video signal is input

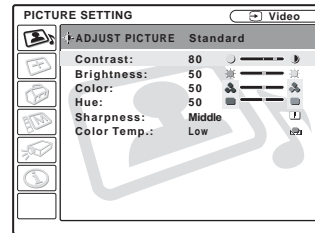

### When the RGB signal is input

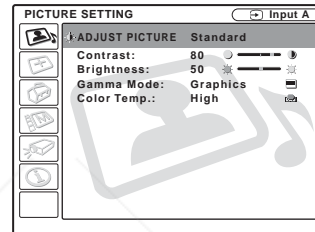

## Contrast

Adjusts the picture contrast. The higher the setting, the greater the contrast between a dark portion and a bright portion of the picture. The lower the setting, the lower the contrast.

## Brightness

Adjusts the picture brightness. The higher the setting, the brighter the picture. The lower the setting, the darker the picture.

## Color

Adjusts color intensity. The higher the setting, the greater the intensity. The lower the setting, the lower the intensity.

## Hue

Adjusts color tones. The higher the setting, the picture becomes greenish. The lower the setting, the picture becomes purplish.



FixYourDLP.com

Discount-Merchant.com 1-888-3860  
THE TRUSTED SOURCE FOR PROJECTOR LAMPS AND ACCESSORIES

---

## Sharpness

Selects the picture sharpness from among “High,” “Middle” and “Low.” The “High” setting makes the picture sharp; the “Low” setting makes it soft.

---

## Gamma Mode

Selects a gamma correction curve.

**Graphics:** Improves the reproduction of halftones. Photos can be reproduced in natural tones.

**Text:** Contrasts black and white. Suitable for images that contain lots of text.

---

## Color Temp.

Adjusts the color temperature.

**High:** Makes the white color bluish.

**Low:** Makes the white color reddish.

---

# The INPUT SETTING Menu

The INPUT SETTING menu is used to adjust the input signal.

Items that cannot be adjusted depending on the input signal are not displayed in the menu.

*For details on the unadjustable items, see page 49.*

## When the video signal is input

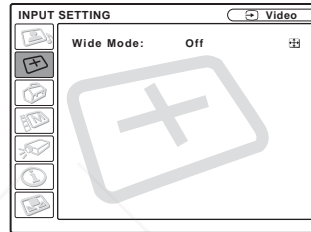

## When the RGB signal is input

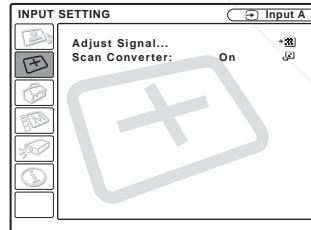

---

## MENU Items

---

### Wide Mode

Sets the aspect ratio of the picture. When inputting 16:9 (squeezed) signal from equipment such as a DVD player, set to On.

**Off:** When the picture with ratio 4:3 is input.

**On:** When the picture with ratio 16:9 (squeezed) is input.

#### Note

Note that if the projector is used for profit or for public viewing, modifying the original picture

by switching to the wide mode may constitute an infringement of the rights of authors or producers, which are legally protected.

### Adjust Signal... Menu Items (Only when the RGB signal is input)

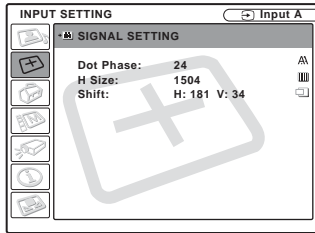

#### Dot Phase

Adjusts the dot phase of the LCD panel and the signal output from a computer. Adjust the picture further for finer picture after the picture is adjusted by pressing the APA key. Adjust the picture to where it looks clearest.

#### H Size

Adjusts the horizontal size of picture output from a connector. The higher the setting, the larger the horizontal size of the picture. The lower the setting, the smaller the horizontal size of the picture. Adjust the setting according to the dots of the input signal.

*For details on the suitable value for the preset signals, see page 50.*

#### Shift

Adjusts the position of the picture. H adjusts the horizontal position of the picture. V adjusts the vertical position of the picture. As the setting for H increases, the picture moves to the right, and as the setting decreases, the picture moves to the left. As the setting for V increases, the picture moves up, and as the setting decreases, the picture moves down. Use the ◀ or the ▶ key to adjust the horizontal position and the ▲ and ▼ key for the vertical position.

### Scan Converter

Converts the signal to display the picture according to the screen size.

**On:** Displays the picture according to the screen size. The picture will lose some clarity.

**Off:** Displays the picture while matching one pixel of input picture element to that of the LCD. The picture will be clear but the picture size will be smaller.

#### Note

- When SVGA or XGA signal is input, this item will not be displayed.

#### Note on selecting the wide mode

Note that if the projector is used for profit or for public viewing, modifying the original picture by switching to the wide mode may constitute an infringement of the rights of authors or producers, which are legally protected.

### About the Preset Memory No.

This projector has 32 types of preset data for input signals (the preset memory). When a preset signal is input, the projector automatically detects the signal type and recalls the data for the signal from the preset memory to adjust it to an optimum picture. The memory number and signal type of that signal are displayed in the INFORMATION menu (See page 38). You can also adjust the preset data through the INPUT SETTING menu.

This projector has 20 types of user memories for INPUT-A into which you can save the setting of the adjusted data for an unpreset input signal.

When an unpreset signal is input for the first time, a memory number is displayed as 0. When you adjust the data of the signal in the INPUT SETTING menu, it will be registered to the projector. If more than 20 user memories are registered, the newest memory always overwrites the oldest one.

*See the chart on page 50 to find if the signal is registered to the preset memory.*



FixYourDL.com

DiscWorld.com.au  
THE TRUSTED SOURCE FOR PROJECTOR LAMP & ACCESSORIES

Since the data is recalled from the preset memory about the following signals, you can use these preset data by adjusting “H Size.” Make fine adjustment by adjusting “Shift.”

Signal	Memory No.	SIZE
Super Mac-2	23	1312
SGI-1	23	1320
Macintosh 19”	25	1328

**Note**

When the aspect ratio of input signal is other than 4:3, a part of the screen is displayed in black.

# The SET SETTING Menu

The SET SETTING menu is used for changing the settings of the projector.

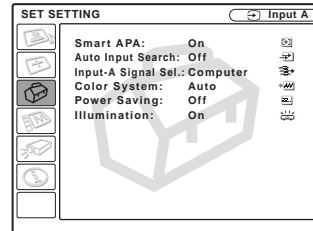

## Menu Items

### Smart APA

Activates or deactivates the Smart APA <sup>1)</sup>.

**On:** Normally select this setting. When a signal is input from a computer, the APA functions automatically so that the picture can be seen clearly. Once the specified input signal has been adjusted by the Smart APA, it will not be readjusted even when the cable is disconnected and connected again or the input channel is changed. You can adjust the picture by pressing APA key on the Remote Commander even if the Smart APA set to “On.”

**Off:** The APA functions when you press the APA key on the Remote Commander.

1) The APA (Auto Pixel Alignment) automatically adjusts “Dot Phase,” “H Size” and “Shift” in the INPUT SETTING menu for the input signal from a computer.

### Auto Input Search

Normally set to “Off.” When set to “On,” the projector detects input signals in the following order: Input-A/Video/S-Video. It indicates the input channel when the power is turned on or the INPUT key is pressed.

Adjustments and Settings Using the Menu



Discount-Merchant.com (800) 281-8860  
THE TRUSTED SOURCE FOR PROJECTOR PARTS AND ACCESSORIES

---

## Input-A Signal Sel.

Selects the computer, component or video GBR signal input from the INPUT A connector.

### Note

If the setting is not correct, the color of the picture becomes strange or “Please check Input-A Signal Sel.” appears on the screen and the picture is not displayed.

---

## Color System

Selects the color system of the input signal. If you select “Auto,” the projector detects the color system of the input signal automatically. If the picture is distorted or colorless, select the color system according to the input signal.

---

## Power Saving

When set to “On,” the projector goes into power saving mode if you do not operate the unit for 10 minutes with no signal input.

---

## Illumination

Selects whether the SONY logo on the rear of the projector lights when the projector is on. Normally, this setting is “On”. If you want complete darkness or if the illuminated logo is a distraction, change this setting to “Off”.

---

# The MENU SETTING Menu

The MENU SETTING menu is used for changing the settings of the projector.

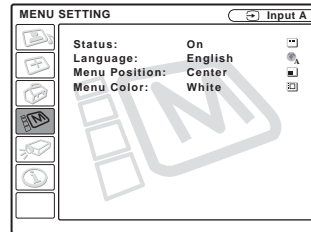

---

## Menu Items

---

### Status (on-screen display)

Sets up the on-screen display.

**On:** Shows all of the on-screen displays.

**Off:** Turns off the on-screen displays except for the menus, a message when turning off the power, and warning messages.

---

### Language

Selects the language used in the menu and on-screen displays. Available languages are: English, Nederlands, Français, Italiano, Deutsch, Español, Português, Русский, Svenska, Norsk, 日本語, 中文 and 한국어.

---

### Menu Position

Selects the display position of the menu from Top Left, Bottom Left, Center, Top Right and Bottom Right.

---

### Menu Color

Selects the tone of the menu display from Black or White.



**Discount-Merchant.com (800) 281-8860**  
**THE TRUSTED SOURCE FOR PROJECTOR LAMPS AND ACCESSORIES**

# The INSTALL SETTING Menu

The INSTALL SETTING menu is used for changing the settings of the projector.

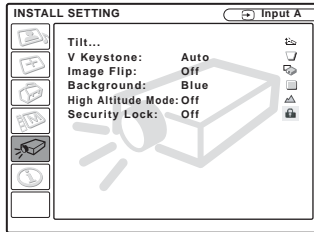

## Menu Items

### Tilt...

Adjusts the position (height) of the projected picture. Pressing the  $\Delta$  on the TILT adjustment key or  $\blacktriangle/\blacktriangleright$  key on the Remote Commander, the more the projector tilts and the higher the position of the picture. Pressing the  $\nabla$  on the TILT adjustment key or  $\blacktriangledown/\blacktriangleleft$  key on the Remote Commander, the less the projector tilts and the lower the position of the picture.

### V Keystone

Corrects the trapezoidal distortion caused by the projection angle. Select "Auto" for automatic correction, or "Manual" for manual correction using the  $\blacktriangleleft$  or  $\blacktriangleright$  key.

**When the bottom of the trapezoid is longer than the top**  $\square$  : Sets a lower value.

**When the top of the trapezoid is longer than the bottom**  $\square$  : Sets a higher value.

### Note

The auto V Keystone adjustment may not correct the trapezoidal distortion perfectly, depending on the room temperature or the screen angle.

### Image Flip

Flips the image on the screen horizontally and/or vertically.

**Off:** The image does not flip.

**HV:** Flips the image horizontally and vertically.

**H:** Flips the image horizontally.

**V:** Flips the image vertically.

### Background

Select the background color of the screen when no signal is input to the projector.

Select black or blue.

Normally set to "blue."

### High Altitude Mode

**Off:** Use this setting when using the projector at normal altitudes.

**On:** Use this setting when using the projector at an altitude of 1,500 m or higher.

### Security Lock

Turns on the projector's security lock function.

**Off:** Turns off the security lock function.

**On:** Turns on the security lock function, which locks the projector once a password has been set.

*For details, see "To use the security lock" on page 25.*



FixYourDLP.com  
Sponsored by DLP

Discount-Merchant.com (800) 281-8860  
THE TRUSTED SOURCE FOR PROJECTOR LAMPS AND ACCESSORIES

# The INFORMATION Menu

The INFORMATION menu displays the horizontal and vertical frequencies of the input signal and the used time of the lamp.

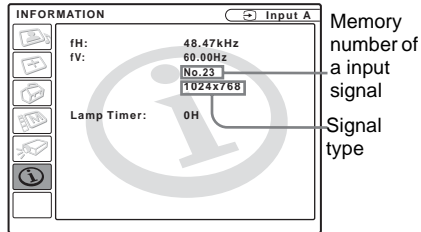

## Menu Items

### fH

Displays the horizontal frequency of the input signal.  
The displayed value is approximate.

### fV

Displays the vertical frequency of the input signal.  
The displayed value is approximate.

### Lamp Timer

Indicates how long the lamp has been turned on.

#### Note

These only display on the screen. You cannot alter the display.



**Discount-Merchant.com (800) 281-8860**  
**THE TRUSTED SOURCE FOR PROJECTOR LAMPS AND ACCESSORIES**

## Maintenance

### Replacing the Lamp

Replace the lamp with a new one in the following case.

- When the lamp has burnt out or dims
  - “Please replace the LAMP.” appears on the screen
  - The LAMP/COVER indicator lights up
- The lamp life varies depending on conditions of use. Use LMP-E180 Projector Lamp as the replacement lamp.

#### When replacing the lamp after using the projector

Turn off the projector, then unplug the power cord.  
Wait for at least an hour for the lamp to cool.

#### Caution

The lamp becomes a high temperature after turning off the projector with the I / ⏻ key. **If you touch the lamp, you may scald your finger. When you replace the lamp, wait for at least an hour for the lamp to cool.**

#### Notes

- **If the lamp breaks, consult with qualified Sony personnel.**
- Pull out the lamp by holding the handle. If you touch the lamp, you may be burned or injured.
- When removing the lamp, make sure it remains horizontal, then pull straight up. Do not tilt the lamp. If you pull out the lamp while tilted and if the lamp breaks, the pieces may scatter, causing injury.

- 1 Place a protective sheet (cloth) beneath the projector. Turn the projector over so you can see its underside.

#### Note

Be sure that the projector is stable after turning it over.

- 2 Open the lamp cover by loosening a screw with the Phillips screwdriver.

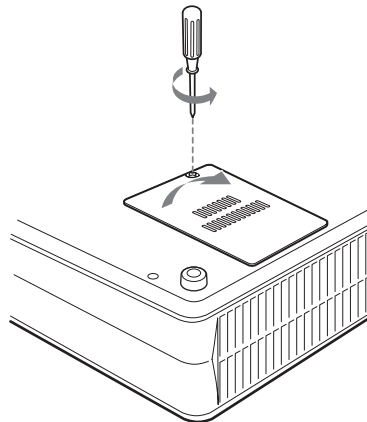

#### Note

For safety sake, do not loosen any other screws.

- 3 Loosen the two screws on the lamp unit with the Phillips screwdriver. Pull out the lamp unit by the handle.

Screws on the lamp (2)

Bottom

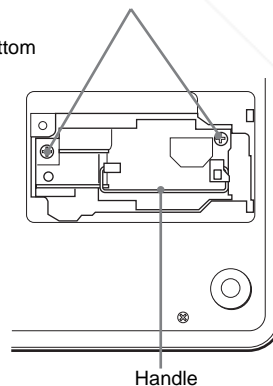

Handle

Maintenance

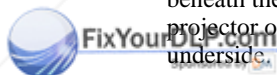

Discount-Merchant.com (800) 281-8860  
THE TRUSTED SOURCE FOR PROJECTOR LAMPS AND ACCESSORIES



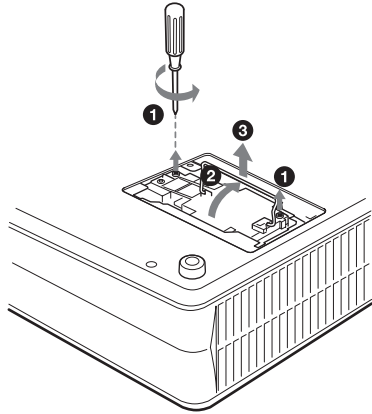

- 4 Insert the new lamp all the way in until it is securely in place. Tighten the screws. Fold the handle.

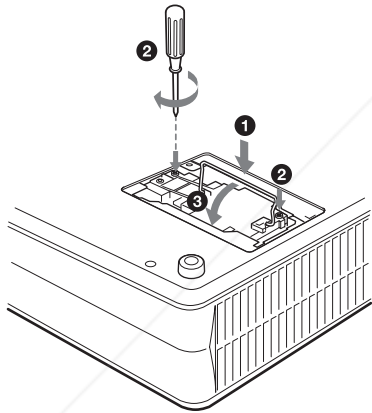

#### Notes

- Be careful not to touch the glass surface of the lamp.
- The power will not turn on if the lamp is not secured properly.

- 5 Close the lamp cover and tighten the screws.

- 6 Turn the projector back over.

- 7 Connect the power cord. The ON/STANDBY indicator around the I/⏻ key lights in red.

- 8 Press the following keys on the remote commander in the following order for less than five seconds each: RESET, ◀, ▶, ENTER.

#### Notes

- **Be sure to use the LMP-E180 Projector Lamp for replacement.** If you use lamps other than LMP-E180, the projector may cause a malfunction.
- Be sure to turn off the projector and unplug the power cord before replacing the lamp.
- Do not put your hands into the lamp replacement spot, or not fall any liquid or object into it **to avoid electrical shock or fire**

#### Disposal the used lamp

As the used lamp contains Mercury, dispose of the lamp according to local, state or federal laws.

As the materials used in this lamp are similar to those of a fluorescent lamp, you should dispose of a used projector lamp in the same way as a fluorescent lamp.



FixYourDLP.com  
Sponsored by

Discount-Merchant.com (800) 281-8860  
THE TRUSTED SOURCE FOR PROJECTOR LAMPS AND ACCESSORIES

## Cleaning the Air Filter

The air filter should be cleaned every 500 hours.

Remove dust from the outside of the ventilation holes with a vacuum cleaner when the message “Please clean the filter” appears in the display.

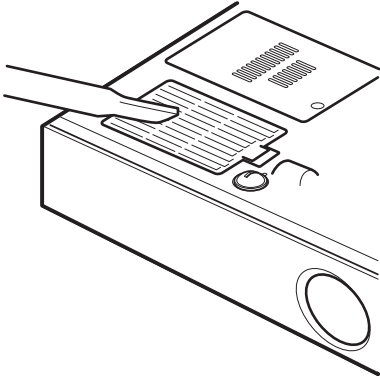

When it becomes difficult to remove the dust from the filter with a vacuum cleaner, remove the air filter and wash it.

- 1 Turn off the power and unplug the power cord.
- 2 Place a protective sheet (cloth) beneath the projector and turn the projector over.
- 3 Remove the air filter cover.

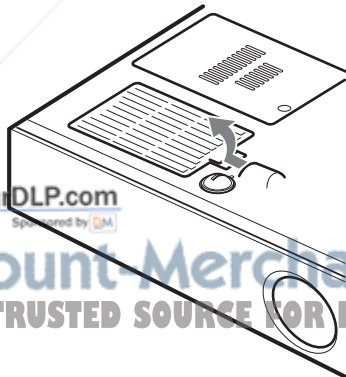

- 4 Remove the air filter.

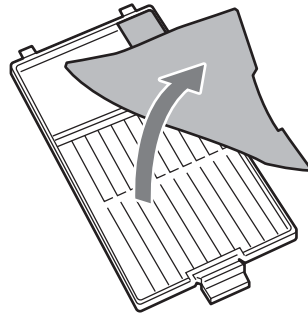

- 5 Wash the air filter with a mild detergent solution and dry it in a shaded place.

- 6 Attach the air filter and replace the cover.

### Notes

- **If you neglect to clean the air filter, dust may accumulate, clogging it. As a result, the temperature may rise inside the unit, leading to a possible malfunction or fire.**
- If the dust cannot be removed from the air filter, replace the air filter with the supplied new one.
- Be sure to attach the air filter cover firmly. Otherwise, dust may accumulate inside the projector, leading to a possible malfunction.
- The air filter has a face and a reverse side. Place the air filter so that it fits in a notch on the air filter cover.

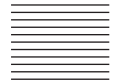

Maintenance

FixYourDLP.com  
Sponsored by DM

DiscountMerchant.com (800) 281-8860  
THE TRUSTED SOURCE FOR PROJECTOR LAMPS AND ACCESSORIES

# Troubleshooting

If the projector appears to be operating erratically, try to diagnose and correct the problem using the following instructions. If the problem persists, consult with qualified Sony personnel.

## Power

Symptom	Cause and Remedy
The power is not turned on.	<ul style="list-style-type: none"> <li>The power has been turned off and on with the I / ⏻ key at a short interval.                             <ul style="list-style-type: none"> <li>→ Wait for about 90 seconds before turning on the power (see page 27).</li> </ul> </li> <li>The lamp cover is detached.                             <ul style="list-style-type: none"> <li>→ Close the lamp cover securely (see page 39).</li> </ul> </li> </ul>
Both the LAMP/COVER and TEMP/FAN indicators light up.	<ul style="list-style-type: none"> <li>The electrical system breaks down.                             <ul style="list-style-type: none"> <li>→ Consult with qualified Sony personnel.</li> </ul> </li> </ul>
The powered tilt adjuster and the lens protector do not close.	<ul style="list-style-type: none"> <li>The AC power cord is unplugged with the power of the projector turned on.                             <ul style="list-style-type: none"> <li>→ Connect the power cord plug to the AC outlet again, then turn off the power of the projector.</li> </ul> </li> </ul>
The powered tilt adjuster and the lens protector do not work at all.	<ul style="list-style-type: none"> <li>The electrical system breaks down.                             <ul style="list-style-type: none"> <li>→ Consult with qualified Sony personnel. If it is necessary to use the projector in case of emergency, use it in the emergency mode (see page 46).</li> </ul> </li> </ul>

## Picture

Symptom	Cause and Remedy
No picture.	<ul style="list-style-type: none"> <li>Cable is disconnected or the connections are wrong.                             <ul style="list-style-type: none"> <li>→ Check that the proper connections have been made (see page 17).</li> </ul> </li> <li>Input selection is incorrect.                             <ul style="list-style-type: none"> <li>→ Select the input source correctly using the INPUT key (see page 24).</li> </ul> </li> <li>The computer signal is not set to output to an external monitor or set to output both to an external monitor and a LCD monitor of a computer.                             <ul style="list-style-type: none"> <li>→ Set the computer signal to output <b>only</b> to an external monitor (see page 17).</li> <li>→ Depending on the type of your computer, for example a notebook, or an all-in-one LCD type, you may have to switch the computer to output to the projector by pressing certain keys or by changing your computer's settings. (See page 24)</li> <li><i>For details, refer to the computer's operating instructions supplied with your computer.</i></li> </ul> </li> </ul>
The picture is noisy.	<ul style="list-style-type: none"> <li>Noise may appear on the background depending on the combination of the numbers of dot input from the connector and numbers of pixel on the LCD panel.                             <ul style="list-style-type: none"> <li>→ Change the desktop pattern on the connected computer.</li> </ul> </li> </ul>

Symptom	Cause and Remedy
The picture from INPUT A connector is colored strange.	<ul style="list-style-type: none"> <li>Setting of “Input-A Signal Sel.” in the SET SETTING menu is incorrect.               <ul style="list-style-type: none"> <li>→ Select “Computer,” “Video GBR” or “Component” correctly according to the input signal (see page 36).</li> </ul> </li> </ul>
“Please check Input-A Signal Sel.” appears in spite of inputting the correct signal from INPUT A.	<ul style="list-style-type: none"> <li>Setting of “Input-A Signal Sel.” in the SET SETTING menu is incorrect.               <ul style="list-style-type: none"> <li>→ Select “Computer,” “Video GBR” or “Component” correctly according to the input signal (see page 36).</li> </ul> </li> </ul>
On-screen display does not appear.	<ul style="list-style-type: none"> <li>“Status” in the MENU SETTING menu has been set to “Off.”               <ul style="list-style-type: none"> <li>→ Set “Status” in the MENU SETTING menu to “On” (see page 36).</li> </ul> </li> </ul>
Color balance is incorrect.	<ul style="list-style-type: none"> <li>Picture has not been adjusted properly.               <ul style="list-style-type: none"> <li>→ Adjust the picture (see page 32).</li> </ul> </li> <li>Projector is set to wrong color system.               <ul style="list-style-type: none"> <li>→ Set “Color System” in the SET SETTING menu to match the color system being input (see page 36).</li> </ul> </li> </ul>
The picture is too dark.	<ul style="list-style-type: none"> <li>Contrast or brightness has not been adjusted properly.               <ul style="list-style-type: none"> <li>→ Adjust the contrast or brightness in the “Adjust Picture...” menu properly (see page 32).</li> </ul> </li> <li>The lamp has burnt or dims.               <ul style="list-style-type: none"> <li>→ Replace the lamp with a new one (see page 39).</li> </ul> </li> </ul>
The picture is not clear.	<ul style="list-style-type: none"> <li>Picture is out of focus.               <ul style="list-style-type: none"> <li>→ Adjust the focus (see page 24).</li> </ul> </li> <li>Condensation has occurred on the lens.               <ul style="list-style-type: none"> <li>→ Leave the projector for about two hours with the power on .</li> </ul> </li> </ul>
The image extends beyond the screen.	<ul style="list-style-type: none"> <li>The APA key is pressed although there are black edges around the image.               <ul style="list-style-type: none"> <li>→ Display the full image on the screen and press the APA key.</li> <li>→ Adjust “Shift” in the INPUT SETTING menu properly (see page 34).</li> </ul> </li> </ul>
The picture flickers.	<ul style="list-style-type: none"> <li>“Dot Phase” in the INPUT SETTING menu has not been adjusted properly.               <ul style="list-style-type: none"> <li>→ Adjust “Dot Phase” in the INPUT SETTING menu properly (see page 34).</li> </ul> </li> </ul>

Maintenance

## Sound

Symptom	Cause and Remedy
No sound.	<ul style="list-style-type: none"> <li>Cable is disconnected or the connections are wrong.               <ul style="list-style-type: none"> <li>→ Check that the proper connections have been made (see page 17).</li> </ul> </li> <li>The audio connecting cable is incorrect.               <ul style="list-style-type: none"> <li>→ Use a no-resistance stereo audio cable (see page 18).</li> </ul> </li> <li>The sound is not adjusted properly.               <ul style="list-style-type: none"> <li>→ Adjust the sound (see page 25).</li> </ul> </li> </ul>

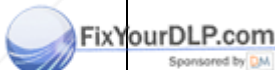

Discount-Merch.com (800) 281-8860  
 THE TRUSTED SOURCE FOR PROJECTOR LAMPS AND ACCESSORIES

## Remote Commander

Symptom	Cause and Remedy
The Remote Commander does not work.	<ul style="list-style-type: none"> <li>The Remote Commander batteries are dead.                             <ul style="list-style-type: none"> <li>→ Replace with a new battery (page 14).</li> </ul> </li> </ul>

## Others

Symptom	Cause and Remedy
The LAMP/COVER indicator flashes.	<ul style="list-style-type: none"> <li>The lamp cover is detached.                             <ul style="list-style-type: none"> <li>→ Attach the cover securely (see page 40).</li> </ul> </li> <li>The lens protector does not open due to a problem.                             <ul style="list-style-type: none"> <li>→ Consult with qualified Sony personnel. If it is necessary to use the projector in case of emergency, use it in the emergency mode (see page 46).</li> </ul> </li> </ul>
The LAMP/COVER indicator lights up.	<ul style="list-style-type: none"> <li>The lamp has reached the end of its life.                             <ul style="list-style-type: none"> <li>→ Replace the lamp (see page 39).</li> </ul> </li> <li>The lamp becomes a high temperature.                             <ul style="list-style-type: none"> <li>→ Wait for 90 seconds to cool down the lamp and turn on the power again (see page 27).</li> </ul> </li> </ul>
The TEMP/FAN indicator flashes.	<ul style="list-style-type: none"> <li>The fan is broken.                             <ul style="list-style-type: none"> <li>→ Consult with qualified Sony personnel.</li> </ul> </li> </ul>
The TEMP/FAN indicator lights up.	<ul style="list-style-type: none"> <li>The internal temperature is unusually high.                             <ul style="list-style-type: none"> <li>→ Check to see if anything is blocking the ventilation holes.</li> <li>→ Check to see whether or not the projector is being used at high altitudes.</li> </ul> </li> </ul>
Both the LAMP/COVER and TEMP/FAN indicators light up.	<ul style="list-style-type: none"> <li>The electrical system breaks down.                             <ul style="list-style-type: none"> <li>→ Consult with qualified Sony personnel.</li> </ul> </li> </ul>

## Warning Messages

Use the list below to check the meaning of the messages displayed on the screen.

Message	Meaning and Remedy
High temp! Probably use in high altitude. Switch to high altitude mode on? Yes ↑ No ↓	<ul style="list-style-type: none"> <li>Internal temperature is too high.                             <ul style="list-style-type: none"> <li>→ When using the projector at an altitude of 1,500 m or higher, set the setting of “High Altitude Mode” in the INSTALL SETTING menu to on. (see page 37)</li> </ul> </li> <li>If this message appears on the screen when using the projector at normal altitudes, check to see if anything is blocking the ventilation holes (exhaust).</li> </ul>
High temp! Lamp off in 1 min.	<ul style="list-style-type: none"> <li>Internal temperature is too high.                             <ul style="list-style-type: none"> <li>→ Turn off the power.</li> <li>→ Check to see if anything is blocking the ventilation holes.</li> </ul> </li> </ul>
Frequency is out of range!	<ul style="list-style-type: none"> <li>This input signal cannot be projected as the frequency is out of the acceptable range of the projector.                             <ul style="list-style-type: none"> <li>→ Input a signal that is within the range of the frequency.</li> </ul> </li> <li>The resolution setting of the output signal of a computer is too high.                             <ul style="list-style-type: none"> <li>→ Set the setting of output to SVGA (see page 17).</li> </ul> </li> </ul>

Message	Meaning and Remedy
Please check Input-A Signal Sel.	<ul style="list-style-type: none"> <li>You have input RGB signal from the computer when “Input-A Signal Sel.” in the SET SETTING menu is set to “Component.”</li> <li>→ Set “Input-A Signal Sel.” correctly (see page 36).</li> </ul>
Please replace the LAMP.	<ul style="list-style-type: none"> <li>It is time to replace the lamp.</li> <li>→ Replace the lamp. (see page 39)</li> </ul>
Please clean the filter.	<ul style="list-style-type: none"> <li>It is time to clean the filter.</li> <li>Clean the filter. (see page 41)</li> </ul>

## Caution Messages

Use the list below to check the meaning of the messages displayed on the screen.

Message	Meaning and Remedy
Not applicable!	<ul style="list-style-type: none"> <li>You have pressed the wrong key.</li> <li>→ Press the appropriate key.</li> </ul>



**Discount-Merchant.com (800) 281-8860**  
**THE TRUSTED SOURCE FOR PROJECTOR LAMPS AND ACCESSORIES**

## On the emergency mode

Before performing the following procedure, try to diagnose the problem using the instructions described in “Troubleshooting” on page 42. If the problem persists, read and following procedure thoroughly and then proceed.

The projector is equipped with the emergency mode for the lens protector and the powered tilt adjuster. If the powered function does not work, you can operate the lens protector and the tilt adjuster (emergency mode) manually.

### Note

Perform this procedure only in an emergency case. You cannot recover the powered function yourself if you perform this procedure. After you use the projector in the emergency mode, consult with qualified Sony personnel immediately.

**To switch to the emergency mode, follow the steps below.**

- 1 Place a protective sheet (cloth) beneath the projector. Turn the projector over so you can see its underside.

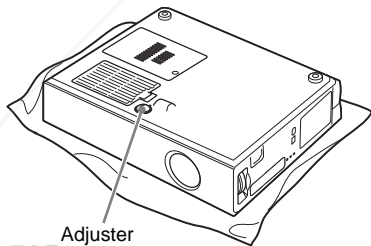

Adjuster



FixYourDLP.com

Sponsored by DM

Discount-Merchant.com (800) 281-8860

THE TRUSTED SOURCE FOR PROJECTOR LAMPS AND ACCESSORIES

- 2 Slide switch **A** in the slit in front of the adjuster in the direction of the arrow (toward the front panel of the projector) with the small minus screwdriver.

The lens protector and the tilt adjuster are switched to the emergency mode.

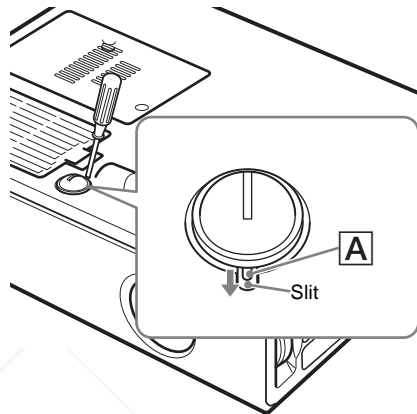

- 3 When opening/closing the lens protector, turn the groove of the adjuster with a coin. When the lens protector is left open, or the tilt adjuster is extended, turn the groove counterclockwise (in direction of the arrow).

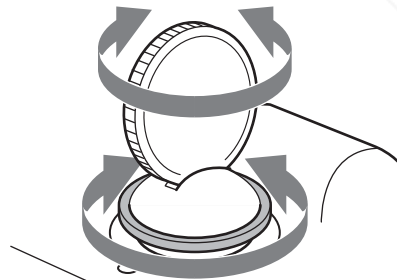

### Note

Turn the projector on when the lens protector on the front of the projector is completely open.

# Specifications

## Optical characteristics

Projection system	3 LCD panels, 1 lens, projection system
LCD panel	Superhigh-aperture 0.62-inch SVGA panel, 1,440,000 pixels (480,000 pixels × 3)
Lens	1.2 times zoom lens (manual) f 18.0 to 21.6 mm/F 2.2 to 2.4
Lamp	157 W UHP
Projection picture size	Range: 40 to 150 inches (diagonal measure)
Light output	ANSI lumen <sup>1)</sup> 1200 lm
Throwing distance (When placing on the floor)	When the SVGA signal is input:
	40-inch: 1.1 to 1.4 m (3.6 to 4.6 feet)
	60-inch: 1.7 to 2.1 m (5.6 to 6.9 feet)
	80-inch: 2.3 to 2.8 m (7.5 to 9.2 feet)
	100-inch: 2.9 to 3.5 m (9.5 to 11.5 feet)
	120-inch: 3.5 to 4.2 m (11.5 to 13.8 feet)
	150-inch: 4.4 to 5.3 m (14.4 to 17.4 feet)

There may be a slight difference between the actual value and the design value shown above.

## Electrical characteristics

Color system	NTSC <sup>3.58</sup> /PAL/SECAM/ NTSC <sup>4.43</sup> /PAL-M/PAL-N system, switched automatically/manually
Resolution	600 horizontal TV lines (Video input) 800 × 600 dots (RGB input)
Acceptable computer signals <sup>2)</sup>	fH: 19 to 72 kHz fV: 48 to 92 Hz (Maximum input signal resolution: XGA 1024 × 768 fV: 85 Hz)

## Applicable video signals

	15 kHz RGB/Component 50/60 Hz, Progressive Component 50/60 Hz, DTV (480/60I, 575/50I, 1080/60I, 480/60P, 575/50P, 1080/50I, 720/60P, 720/50P, 540/60P), Composite video, Y/C video
Speaker	Monaural speaker system, 40 × 20 mm (1 <sup>5</sup> / <sub>8</sub> × 1 <sup>3</sup> / <sub>16</sub> inches), max. 1 W

## Input/Output

Video input	VIDEO: phono type Composite video: 1 Vp-p ±2 dB sync negative (75 ohms terminated) S VIDEO: Y/C mini DIN 4-pin type (male) Y (luminance): 1 Vp-p ±2 dB sync negative (75 ohms terminated) C (chrominance): burst 0.286 Vp-p ±2 dB (NTSC) (75 ohms terminated), burst 0.3 Vp-p ±2 dB (PAL) (75 ohms terminated) HD D-sub15-pin (female) Analog RGB/component: R/R-Y: 0.7 Vp-p ±2 dB (75 ohms terminated) G: 0.7 Vp-p ±2 dB (75 ohms terminated) G with sync/Y: 1 Vp-p ±2 dB sync negative (75 ohms terminated) B/B-Y: 0.7 Vp-p ±2 dB (75 ohms terminated) SYNC/HD: Composite sync input: 1-5 Vp-p high impedance, positive/negative Horizontal sync input: 1-5 Vp-p high impedance, positive/negative VD: Vertical sync input: 1-5 Vp-p high impedance, positive/negative
INPUT A	
AUDIO	Stereo minijack 500 mVrms, impedance more than 47 kilohms

Other



FixYourDLP.com

Sponsored by

Discount-Merchant.com (800) 281-8860

THE TRUSTED SOURCE FOR PROJECTOR LAMPS AND ACCESSORIES

1) ANSI lumen is a measuring method of American National Standard IT 7.228.

2) Set the resolution and the frequency of the signal of the connected computer within the range of acceptable preset signals of the projector.



#### Safety regulations

UL60950, cUL (CSA No. 60950),  
FCC Class B, IC Class B,  
NEMKO (EN60950), CE  
(LVD, EMC), C-Tick

#### General

Dimensions 295 × 78 × 238 mm (11 <sup>5</sup>/<sub>8</sub> ×  
3 <sup>1</sup>/<sub>8</sub> × 9 <sup>3</sup>/<sub>8</sub> inches) (w/h/d)  
(without the projection parts)

Mass Approx. 2.8 kg (6 lb 3 oz)

Power requirements  
AC 100 to 240 V, 50/60 Hz

Power consumption  
Max. 250 W  
(Standby mode: 4.6 W)

Heat dissipation  
853.1 BTU

Operating temperature  
0°C to 35°C (32°F to 95°F)

Operating humidity  
35% to 85% (no condensation)

Storage temperature  
-20°C to 60°C (-4°F to 140°F)

Storage humidity  
10% to 90%

Supplied accessories  
Remote Commander (1)  
Lithium battery CR2025 (1)  
HD D-sub 15 pin cable (2 m) (1)  
(1-791-992-21)  
Soft case (1)  
AC power cord (1)  
Air filter (for replacement) (1)  
Operating Instructions (1)  
Quick Reference Card (1)  
Security Label (1)

Design and specifications are subject to change  
without notice.

#### Optional accessories

Projector Lamp  
LMP-E180 (for replacement)

Signal Cable SMF-402 (HD D-sub 15-pin  
(male) ↔ 3 × phono type  
(male))

#### Pin assignment

#### INPUT A connector (HD D-sub 15-pin, female)

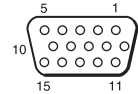

1	R/R-Y	9	N.C.
2	G/Y	10	GND
3	B/B-Y	11	GND
4	GND	12	DDC/SDA
5	GND	13	HD/C.Sync
6	GND (R)	14	VD
7	GND (G)	15	DDC/SCL
8	GND (B)		



**Discount-Merchant.com (800) 281-8860**  
**THE TRUSTED SOURCE FOR PROJECTOR LAMPS AND ACCESSORIES**

## Input signals and adjustable/ setting items

### Adjust Picture... menu

Item	Input signal			
	Video or S video (Y/C)	Com- ponent	Video GBR	Com- puter
Contrast	●	●	●	●
Brightness	●	●	●	●
Color	● (except black and white signal)	●	●	–
Hue	● (except black and white signal) (NTSC 3.58/4.43 only)	●	●	–
Sharpness	●	●	●	–
Gamma Mode	–	–	● (preset memory no.3,4 only)	●
Color Temp.	●	●	●	●
Volume	●	●	●	●

● : Adjustable/can be set  
– : Not adjustable/cannot be set

## INPUT SETTING menu

Item	Input signal			
	Video or S video (Y/C)	Com- ponent	Video GBR	Com- puter
Dot Phase	–	–	–	●
H Size	–	● (except preset memory no. 3, 4)	● (except preset memory no. 3, 4)	●
Shift	–	● (except preset memory no. 3, 4)	● (except preset memory no. 3, 4)	●
Scan Converter	–	–	–	● (lower than VGA)
Wide Mode	●	● (except preset memory no. 5, 45, 47, 48, 50)	● (except preset memory no. 5, 45, 47, 48, 50)	–

● : Adjustable/can be set  
– : Not adjustable/cannot be set

Other

## Preset signals

Memory No.	Preset signal		fH (kHz)	fV (Hz)	Sync	SIZE
1	Video 60 Hz		15.734	59.940		
2	Video 50 Hz		15.625	50.000		
3	15k RGB/Component 60 Hz		15.734	59.940	S on G/Y or Composite Sync	
4	15k RGB/Component 50 Hz		15.625	50.000	S on G/Y or Composite Sync	
5	1080/60I		33.75	60.0	S on G/Y or Composite Sync	
6	640 × 350	VGA mode 1	31.469	70.086	H-pos, V-neg	800
7		VGA VESA 85 Hz	37.861	85.080	H-pos, V-neg	832
8	640 × 400	PC-9801 Normal	24.823	56.416	H-neg, V-neg	848
9		VGA mode 2	31.469	70.086	H-neg, V-pos	800
10		VGA VESA 85 Hz	37.861	85.080	H-neg, V-pos	832
11	640 × 480	VGA mode 3	31.469	59.940	H-neg, V-neg	800
12		Macintosh 13"	35.000	66.667	H-neg, V-neg	864
13		VGA VESA 72 Hz	37.861	72.809	H-neg, V-neg	832
14		VGA VESA 75 Hz	37.500	75.000	H-neg V-neg	840
15		VGA VESA 85 Hz	43.269	85.008	H-neg V-neg	832
16	800 × 600	SVGA VESA 56 Hz	35.156	56.250	H-pos, V-pos	1024
17		SVGA VESA 60 Hz	37.879	60.317	H-pos, V-pos	1056
18		SVGA VESA 72 Hz	48.077	72.188	H-pos, V-pos	1040
19		SVGA VESA 75 Hz	46.875	75.000	H-pos, V-pos	1056
20		SVGA VESA 85 Hz	53.674	85.061	H-pos, V-pos	1048
21	832 × 624	Macintosh 16"	49.724	74.550	H-neg, V-neg	1152
22*	1024 × 768	XGA VESA 43 Hz	35.524	86.958	H-pos, V-pos	1264
23		XGA VESA 60 Hz	48.363	60.004	H-neg V-neg	1344
24		XGA VESA 70 Hz	56.476	69.955	H-neg V-neg	1328
25		XGA VESA 75 Hz	60.023	75.029	H-pos, V-pos	1312
26		XGA VESA 85 Hz	68.677	84.997	H-pos, V-pos	1150
43	480/60P (Progressive component)		31.470	60.000	Son G	
44	575/50P (Progressive component)		31.250	50.000	Son G	
45	1080/50I (DTV)		28.130	50.000		
47	720/60P (DTV)		45.000	60.000		
48	720/50P (DTV)		37.500	50.000		
50	546/60P		33.750	60.000		

### Notes

- When a signal other than the preset signals shown above is input, the picture may not appear properly.
- Memory No. 22 shows the interlace signal.

### Warning on power connection

Use a proper power cord for your local power supply.

	The United States, Canada		Continental Europe		UK, Ireland, Australia, New Zealand	Japan
Plug type	VM0233	290B	YP-12A	COX-07	_(1)	YP332
Connector type	VM0089	386A	YC-13B	COX-02	VM0310B	YC-13
Cord type	SJT	SJT	H05VV-F	H05VV-F	N13237/ CO-228	VCTF
Rated Voltage & Current	10A/125V	10A/125V	10A/250V	10A/250V	10A/250V	7A/125V
Safety approval	UL/CSA	UL/CSA	VDE	VDE	VDE	DENAN
Cord length (max.)	4.5 m		-			

(1) Use an appropriate rating plug which is applied to local regulations.

Other



**Discount-Merchant.com (800) 281-8860**  
**THE TRUSTED SOURCE FOR PROJECTOR LAMPS AND ACCESSORIES**

# Index

## A

- Adjusting
  - memory of the settings 31
  - the picture .....32
  - the picture size/shift ...34
- Air filter .....41
- Auto Input Search .....35

## B

- Background .....37
- Brightness .....32

## C

- Color .....32
- Color System .....36
- Color Temp. ....33
- Connections
  - component equipment 19
  - computer .....17
  - VCR .....19
- Contrast .....32

## D

- Digital Zoom function ....28
- Dot Phase .....34

## F

- fH (Horizontal Frequency) 38
- fV (Vertical Frequency) .38

## G

- Gamma Mode .....33

## H

- H Size .....34
- High Altitude Mode .....37
- Hue .....32

## I

- Illumination .....36
- Image Flip .....37
- INPUT A connector .....13
  - pin assignment .....48
- Input-A Signal Sel. ....36
- Installation examples ....16
  - notes .....7
  - unsuitable conditions ....7
  - unsuitable installation ..7

## L

- Lamp replacement .....39
- Lamp Timer .....38
- Language .....36
  - selecting the menu
    - language .....21
- Lens protector .....10
  - Lithium battery .....14
- Location and function of controls
  - connector panel .....13
  - control panel .....11
  - rear/right side/bottom .10
  - top/front/left side .....10

## M

- Menu
  - clearing the menu
    - display .....31
  - INFORMATION Menu .38
  - INPUT SETTING menu 33
  - INSTALL SETTING
    - menu .....37
  - MENU SETTING menu 36
  - PICTURE SETTING
    - menu .....32
  - SET SETTING menu .35
    - using the menu .....30
- Menu Color .....36
- Menu Position .....36
- Message
  - caution .....45
  - warning .....44

## O

- Optional accessories .....48

## P

- Picture Mode .....32
- Pin assignment .....48
- Power
  - turn on .....23
- Power Saving .....10, 36
- Powered tilt adjuster .....12
- Precautions .....6

## R

- Remote Commander .....13
  - location and function of controls .....14
- Remote control detector .10
- Reset
  - resettable items .....31
  - resetting the item .....31

## S

- Scan Converter .....34
- Screen size .....16, 47
- Security Lock .....37
- SET SETTING menu ....35
- Sharpness .....33
- Shift .....34
- Smart APA .....35
- Specifications .....47
- Status .....36
- Supplied accessories .....48

## T

- Tilt... .....37
- Troubleshooting .....42

## V

- V Keystone .....37
- Volume .....32

## W

- Wide Mode .....33



FixYourDLP.com

Sponsored by DMI

<http://www.sony.net/>

Printed on 100% recycled paper.

Halogenated flame-retardants are not used in printed wiring boards.

Halogenated flame-retardants are not used in cabinets.

Lead-free solder is used for soldering.

Polystyrene foam for the packaging cushions is not used in packaging.



# Disclaimer

This user manual is provided as a free service by FixYourDLP.com. FixYourDLP is in no way responsible for the content of this manual, nor do we guarantee its accuracy. FixYourDLP does not make any claim of copyright and all copyrights remain the property of their respective owners.

About FixYourDLP.com

FixYourDLP.com (<http://www.fixyourdpl.com>) is the World's #1 resource for media product news, reviews, do-it-yourself guides, and manuals.

Informational Blog: <http://www.fixyourdpl.com>

Video Guides: <http://www.fixyourdpl.com/guides>

User Forums: <http://www.fixyourdpl.com/forum>

FixYourDLP's Fight Against Counterfeit Lamps:

<http://www.fixyourdpl.com/counterfeits>

## Sponsors:

RecycleYourLamp.org – Free lamp recycling services for used lamps:

<http://www.recycleyourlamp.org>

Lamp Research - The trusted 3rd party lamp research company:

<http://www.lampresearch.com>

Discount-Merchant.com – The worlds largest lamp distributor:

<http://www.discount-merchant.com>



**FixYourDLP.com**

Sponsored by 